

T05.6

2 DORMITORIOS +
C/ PALLARS 418, PLANTA 6ª P 4
(418_6-4)

SUPERFICIES

Sup. Útil vivienda: 60,21 m²

Sup. Útil terraza: 9,58 m²

Sup. Const. vivienda: 67,85 m²

Sup. Const. terraza: 10,26 m²

Fachada C/Pallars

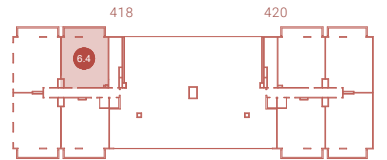

By

GRUPO
ROSALES

Sales Advisor

